

NOTICE OF PROPOSED INSTALLATION
PIPE AND/OR UTILITY LINES

DATE: 5-23-2023

TO: UPSHUR COUNTY COMMISSIONERS COURT
c/o UPSHUR COUNTY ENGINEER
UPSHUR COUNTY ROAD & BRIDGE DEPARTMENT
P. O. BOX 730
Gilmer, TX 75644

EXPIRES: _____

Formal notice is hereby given that TWS proposes to ^{Run} bore a 4" line within the right-of-way of County Road Fawn Crossing as follows: TWS Management, Inc. proposes to enter Right of way on Fawn Crossing on South & West side of same for a 4" water main, 1000' in length with a 149A tracer wire and a minimum Dept of 36" as indicated on attached maps

The location and description of the proposed line and appurtenances is more fully shown by three copies of drawings attached to this notice. The line will be constructed and maintained on the County right-of-way as directed by the County Engineer in accordance with current Upshur County specifications.

Construction of this line will begin on or after the 12th day of June 20 23 and will be completed within 90 days of the date of approval.

Firm TWS Management
By Dave Ode
Title MGR
Address 7891 Hwy 221
Tyler, TX. 75708

903-216-0750

- NOTE: 1. This form to be submitted in triplicate for each proposed installation.
2. The permit shall be in effect until the utility line is removed from the right of way.
3. Inform the County Engineer if work is not completed within this time.

750

N

Gilmer Lake Boat Ramp

1000' 4" PVC WATER MAIN
WITH 1494 TRACER WIRE

Fallow Tr

Katie Ln

Fawn Crossing

852

W

852

Fawn Crossing

Dud's on the Lake
Temporarily closed

852

Magore Ln

Lean Rd

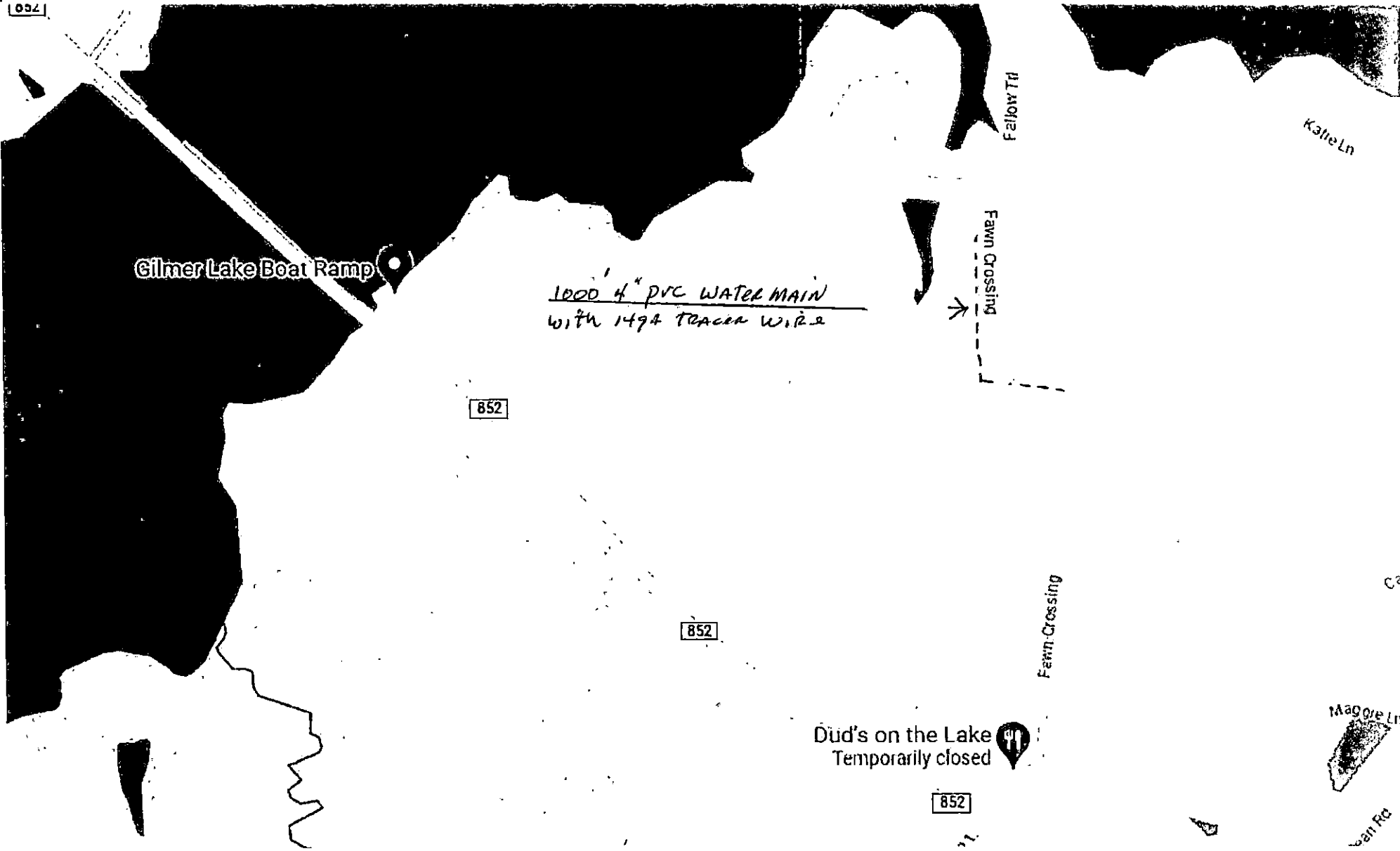

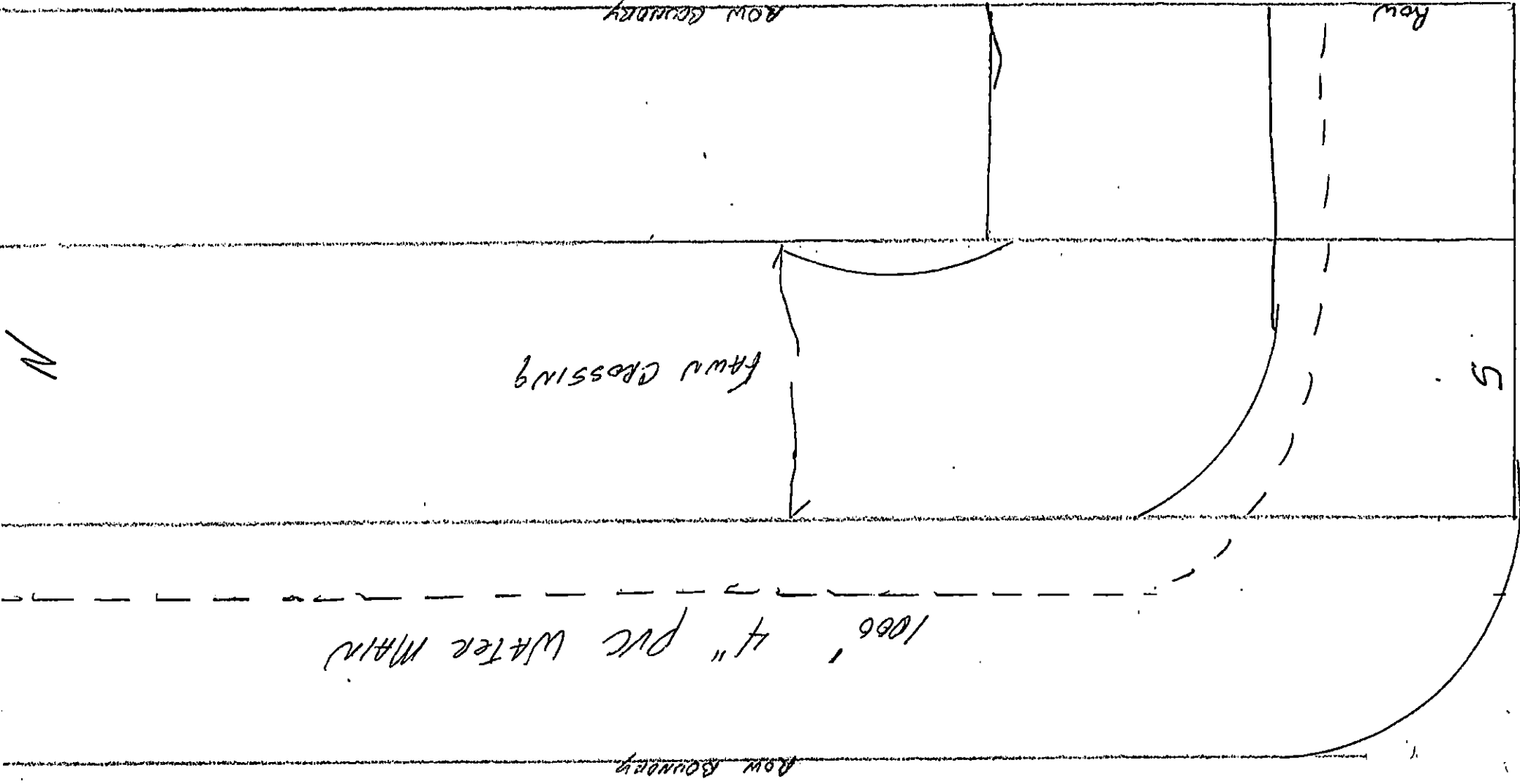

APPROVAL

TO: Texas Water Systems
7891 Hwy 271
Tyler, TX 75708

DATE July 6, 2023

The Upshur County Commissioners Court offers no objections to the location on the right-of-way of your proposed water line across Fawn Crossing Road as shown by accompanying drawings and notice dated 5/23/2023, except as noted below:

N/A

It is expressly understood that the Upshur County Commissioners Court does not purport, hereby, to grant and right, claim, title, or easement in or upon this county road; and it is further understood that in the future should for any reason Upshur County need to work, improve, relocate, widen, increase add to or any manner change the structure of this right-of-way line, this line, if affected, will be moved under the direction of the Upshur County Engineer and shall be relocated at the complete expense of the owner. Upshur County shall be notified a minimum of 48 hours prior to the beginning of any work.

All work on the county right-of-way shall be performed in accordance with the County Engineer's instructions. The installation shall not damage any part of the highway and adequate provisions must be made to cause minimum inconvenience to traffic and adjacent property owners. Special specifications for placing this line are as follows:

1. All ground lines are to be installed a minimum of 36 inches below the flowline of the adjacent drainage or borrow ditch.
2. All excavations within the right-of-way and not under surfacing shall be backfilled by tamping in 6 inch horizontal layers. All surplus material shall be removed from the right-of-way and the excavation finished flush with surrounding natural ground.
3. Lines crossing under surfaced roads and under surfaced cross roads within the right-of-way shall be placed by boring. Boring shall extend from crown line to crown line.
4. All lines under roads carrying pressure in excess of 50 psi shall be enclosed in satisfactory casing extending from right-of-way line to right-of-way line. Pipe used for casing may be of any type approved by the County Engineer and shall be capable of Supporting the load of roadbed and traffic and shall be so constructed that there will be no leakage of any matter through the casing for its entire length. Inside diameter of casing shall be at least 2 inches greater than the largest outside diameter of carrier pipe, joint or couplings. (Encasement is not required on lines installed 48 inches or greater below flowline.)
5. All lines, where practicable, shall be located to cross roadbed at approximately right angles thereto. No lines are to be installed under or within 50 feet of either end of a bridge unless approved by the County Engineer in writing. No lines shall be placed inside any culvert or within 10 feet of the closest point of same.
6. Parallel lines will be installed as near the right-of-way lines as is possible and no parallel line will be installed in the roadbed or between the drainage ditch and roadbed unless approved by the County Engineer in writing.
7. Overhead lines will have a minimum clearance of 18 feet above the road surface at point of crossing.
8. Operations along roadways shall be performed in such a manner that all excavated material be kept off the pavements at all times, as well as all operating equipment and materials. Do not use equipment or installation procedures which will damage any road surface or structure. The cost of any repairs to road surfaces, roadbed, structures or other right-of-way features as direct result of this installation will be borne by the owner of this line.
9. Barricades, warning signs, lights and flagmen, when necessary, shall be provided by the contractor or owner. One half of the traveled portion of the road must be open to traffic at all times. All traffic control shall be in accordance with the requirements of the current version of the Texas MUTCD.
10. Utility company shall install adequate erosion control measures for any excavation work being performed.

APPROVED: _____

Road Administrator

APPROVED: _____

Chairperson, Upshur County Commissioners Court
Revised 11/30/10

SPECIAL ROAD USE AGREEMENT CONTRACT

THE STATE OF TEXAS } KNOW ALL MEN BY THESE PRESENTS:
 COUNTY OF UPSHUR }

The undersigned, Shafer Land & Timber , hereinafter referred to as First Party, enters into an agreement with Upshur County Commissioner of Precinct No. 2 , Upshur County, and in order to get material to market it is necessary to use a portion of Upshur County roads located in Precinct No. 2 , over which Commissioner has jurisdiction and obligation to maintain in good repair, and both parties being aware of possible damage to said roads as a result of hauling on and over same, enter into the following agreement:

1.
 First Party agrees to use only that section of (described exact route, direction and miles in tenths)
 1/4 mile on Peony Road

2.
 First Party agrees to use its vehicles in such a manner as not to block or interfere with other traffic on said road, so that said road will be open to travel by the public at all times.

3.
 First Party agrees to grade, maintain and otherwise repair said road, using its own equipment, labor and materials, if any needed, during the duration of time that First Party is hauling logs from lands location in Precinct No. 2 , Upshur County.

4.
 First Party agrees to put said road back into same condition as it was prior to the commencement of hauling operations on the part of First Party.

5.
 First Party agrees to POST PERFORMANCE BOND in the amount of \$-0-, to Upshur County Commissioner’s Court to insure performance of agreement.

6.
 Nothing herein shall be construed as a waiver by the Commissioner of the authority granted him by Article 6716, V.A.C.S., but the rights and authority granted the Commissioner by the terms of Article 6716, V.A.C.S., are expressly reserved by the Commissioner in the event First Party fails to abide by the conditions above set forth.



First Party Signature

3400 L Marshall Ave
Street or Box

Longview TX 75601
City, State and Zip Code

903-803-1440
Telephone

Caldwell, Robbie
Timber Tract / Property Owner

Issued by Lisa Jeffers Valid 6/20/23 to 9/20/23

PERMIT ISSUED NOT TO EXCEED 90 DAYS UNLESS OTHERWISE NOTED

COPY OF THIS PERMIT MUST BE IN EVERY TRUCK BEING USED

*****A TEMPORARY CULVERT MUST BE INSTALLED IN DITCH BEING
USED FOR ACCESS TO LAND*****

DRIVEWAY PERMIT APPLICATION

TO: THE UPSHUR COUNTY COMMISSIONERS COURT
COUNTY OF UPSHUR
GILMER, TEXAS

PRECINCT 3

DATE June 15, 2023

Formal notice is hereby given that Layne Mueller, whose principal address is 1720 Holly Rd., Gilmer Texas 75644, does hereby purpose to place a within the ROW of County Road Holly. Proposed construction will begin, if approved, on or after the 30th day of June, 2023 I, Layne Mueller, hereby attest that I have read the conditions set forth in this application and understand its contents. The culvert * will/ will not be placed by County equipment and personnel. This is a * new installation extension.

SIGNATURE: Layne Mueller

TELEPHONE: 214-876-9731

APPROVAL OF PERMIT APPLICATION

The Upshur County Commissioners Court offers no objection to the location on the right of way of your proposed driveway culvert for the address shown above. The proposed driveway structure will be a "x" culvert. (TBD)

Recommended by Step

APPROVED ON THIS DAY OF , 20 .



DRIVEWAY PERMIT APPLICATION

TO: THE UPSHUR COUNTY COMMISSIONERS COURT
COUNTY OF UPSHUR
GILMER, TEXAS

PRECINCT 1

DATE June 15, 2021

Formal notice is hereby given that Thomas Margrave, whose principal address is 4356 Blue, does hereby propose to place a _____ within the ROW of County Road Blue. Proposed construction will begin, if approved, on or after the 15th day of June, 2021. Thomas Margrave, hereby attest that I have read the conditions set forth in this application and understand its contents. The culvert will will not be placed by County equipment and personnel. This is a new installation extension.

SIGNATURE: [Signature]
TELEPHONE: 202-634-0793

APPROVAL OF PERMIT APPLICATION

The Upshur County Commissioners Court offers no objection to the location or the right of way of your proposed driveway culvert for the address shown above. The proposed driveway structure will be a culvert.

Recommended by: [Signature]

APPROVED ON THIS _____ DAY OF _____, 20_____

DRIVEWAY PERMIT APPLICATION

TO: THE UPSHUR COUNTY COMMISSIONERS COURT
COUNTY OF UPSHUR
GILMER, TEXAS

PRECINCT 3

DATE May 31, 2023

Formal notice is hereby given that James Schuler , whose principal address is 445 PR 3101 , does hereby purpose to place a within the ROW of County Road Holly . Proposed construction will begin, if approved, on or after the 15th day of June , 20 23 . I, James Schuler , hereby attest that I have read the conditions set forth in this application and understand its contents. The culvert will/ will not be placed by County equipment and personnel. This is a new installation extension .

SIGNATURE: James Schuler
TELEPHONE: 903-790-4362

APPROVAL OF PERMIT APPLICATION

The Upshur County Commissioners Court offers no objection to the location on the right of way of your proposed driveway culvert for the address shown above. The proposed driveway structure will be a "x ' culvert.

Recommended by [Signature]

APPROVED ON THIS _____ DAY OF _____, 20 .